



MOUNTING ISTRUCTIONS
v1.0
Code: **AWO171EMT**
Name: **DSC BOX EMPTY**
Metal casing for: SSWiN, KD,....

IM171EMT

Edition: 1 from 1.09.2023



1. Destination:

AWO171EMT metal enclosure is designed as components (supplying) in intrusion alarm system, access control systems, security systems etc.

It is intended for installation:

- control panel and optionally additional modules
- access control controllers with optional modules
- radio or GSM transmitter with optional module PS
- other dedicated devices, components etc.
- assembly kit **PKAZ196**, designed for enclosure, includes: tamper of opening and detaching the enclosure, earthing wires, screws ...
- transformers which can be mounted in enclosure: **AWT150**

2. Specifications:

Table 1. Mechanical parameters.

External dimensions of enclosure	W=280, H=295, D=78+6 [+/-2 mm]
External dimensions of front panel	W1=285, H1=300 [+/-2 mm]
Recommended battery/batteries	7 Ah / 12 V (SLA)
Material	DC01 steel plate, thickness: 0,7 mm corrosion protection, Color: RAL 9003
Destination	Inside
Net/gross weight	1,65 / 1,71 [kg]
Notes	Assembly kit PKAZ196, designed for enclosure, includes: tamper of opening and detaching the enclosure, earthing wires, screws ... Possibility of installing lock: MR008 / MR027 Possibility of mount transformer: AWT150
Warranty	2 years

Table 2. Operating parameters.

Protection grade EN60529	IP20
Operating temperature	-10°C ...+40°C
Storage temperature	-20°C ...+60°C
Relative humidity	20%...90%, without condensation
Sinusoidal vibrations during operation	Unacceptable
Impulse waves during operation	
Vibrations and impulse waves during transport	According to PN-83/T-42106

Table 3. Technical data of the transformers, which can be mounted in enclosure:

Code	AWT150
Name	TRP 40/16/18
Supply voltage	~ 230 V; 50 Hz
Current consumption	0,20 A
Output power	40 V A
Power supply output	U1 = 12 V AC / 1,6 A or U2 = 14 V AC / 1,4 A
Fuse in supply circuit 230 V	T 315 mA/250 V
Overheat protection	Fuse 130°C, non-returnable
Enclosure	PC/ABS class UL94-V0, IP30

3. Panels which can be mounted in enclosure.

DSC:

Power Series Neo

Alarm control panels: HS2016, HS2016-4, HS2032, HS2064, HS2128.

Modules: HSM2300, HSM2204, HSM2208, HSM2955, HSM2108, PCL-422.

Communication modules and transmitters: LE2080(R), 3G2080(R), TL280LE(R), TL2803G, TL280(R)E, 3G2080 (with mounting plate)

Power Series

Alarm control panels: PC1616, PC1832, PC1864.

Modules: PC5320, PC5100, PC5108, PC5200, PC5204, PC5400, PC5950, IT-100.

Communication modules and transmitters: 3G2060(R), TL2603G(R), TL260(R) (with mounting plate)

Power Series Pro

Alarm control panels: HS3032, HS3128, HS3248.

Modules: HSM3408, HSM2108, HSM3204CX, HSM3350, AMX-400, 3G/LE9080 (directly on central's PCB).

Documentation shows which devices can be installed in a given enclosure. It does not define how many different devices can be installed in one enclosure. Number of installed devices depends on their size and arrangement.

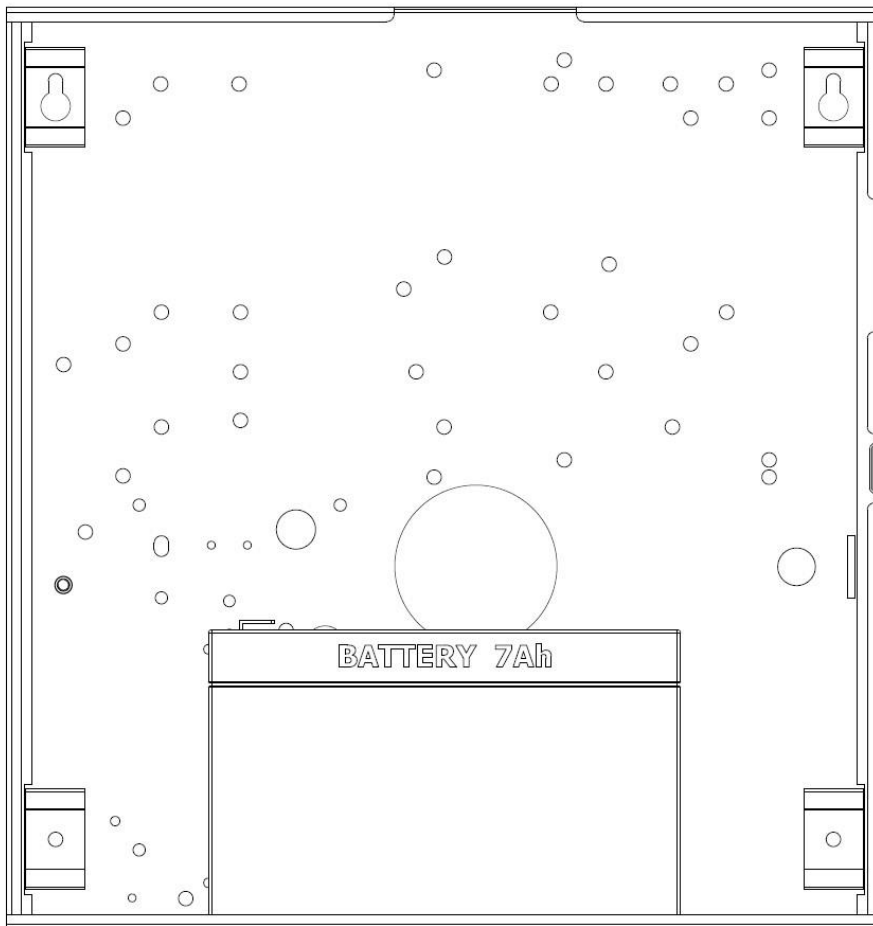

Figure 1. View of enclosure.

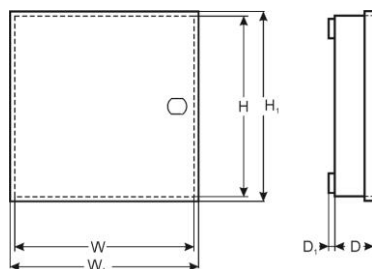

Figure 2. Dimensions.



Device works with a lead-acid battery (SLA). After the operation period it must not be disposed of but recycled according to the applicable law.

Pulsar sp. j.

Siedlec 150, 32-744 Łapczyca, Poland

Tel. (+48) 14-610-19-45

e-mail: sales@pulsar.pl

[http:// www.pulsar.pl](http://www.pulsar.pl)

