

1. Application:

AWO385 metal enclosure is designed for mounting built-in power supplies of the following series:

- **LRS**-35-xx, LRS-50-xx, LRS-75-xx, LRS-100-xx, LRS-150-xx.
- **RS**-15-xx, RS-25-xx, RS-35-xx, RS-50-xx, RS-75-xx, RS100-xx, RS150-xx.
- **PS**-25xxxx, PS-60xxxx, PS-150xxxx.
- **RSP**-100-xx, RSP- 150-xx, RSP-200-xx, RSP-320-xx, RSP-500-xx.
- **PS**-12V2A, PS-12V3A, PS-12V5A, PS-48V1A, PS-12V7A, PS-12V10A, PS-48V3A, PS-12V15A.=

Enclosure is made of steel with a thickness of 0,7mm, in white color RAL9003. It is equipped with a set of M3x4 screws - 4 pieces and M4x4 screws - 4 pieces - for mounting the power supply.

2. Installation:

Enclosure should be mounted by a qualified installer, holding relevant permits and licenses (applicable and required for a given country) for 230 V AC and low-voltage installations. Housing can be mounted inside, at a temperature range from -10°C up to +40°C.

3. Technical parameters

Enclosure: IP	IP20
Application	indoor
Operating temperature	-10°C ÷ 40°C
External dimensions of the enclosure	W=175, H=277, D+D₁=61+8 [+/- 2mm]
External dimensions of the front panel	W₁=180, H₁=281 [+/- 2mm]
Locking	Cylindrical screw x1
Net/Gross weight	0,90 / 1,05 [kg]
Finish	DC01 sheet, thickness: 0,7mm; Corrosion protection Color: RAL 9003 (white)
Notes	The enclosure includes a set of M3x4 screws – 4 pieces and M4x4 screws - 4 pieces Distance from the wall 8mm

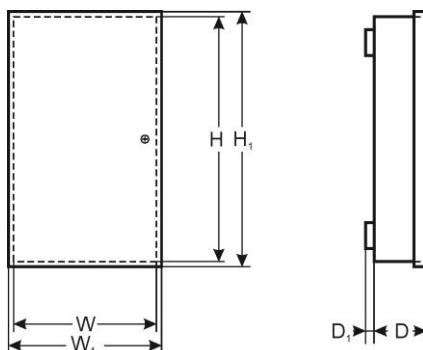

Pulsar sp. j.

Siedlec 150,
32-744 Łapczyca, Poland
Tel. (+48) 14-610-19-45
e-mail: sales@pulsar.pl
[http:// www.pulsar.pl](http://www.pulsar.pl)

