



DESTINATION

These enclosures are designed for the DIN rail mounting of ICT company access control system devices, including:

- Controller Modules:
 - PRT-CTRL-DIN-.... / PRT-WX-DIN-...
- Expander Modules:
 - PRT-RDM2-DIN-... / PRT-HRDM-DIN-... / PRT-ZX16-DIN-... /
- Power Supply Modules:
 - PRT-PSU-DIN-...

The design allows for the mounting of ICT modules in both full-size and half-size formats.

TECHNICAL DATA

Electrical parameters:

Protections:	Tamper protection - opening enclosure, removal from the wall 0.5A / 50 V DC, NC - normally closed
Protection class EN 62368-1:	I (first)
Rated current of protective connection:	6 A max.

Mechanical parameters:

Dimensions:	268 x 372 x 99 [mm, +/-2] distance from surface: 3 mm
External dimensions of front panel:	275 x 378 [mm, +/-2]
Dimensions of battery space :	1 x 7Ah
Material:	steel DC01, RAL9005 (black), metallic, protection anticorrosion
Closing:	Key lock
DIN rail:	1 x 225mm + 1 x 150mm 1 x 1.5 + 1 x 1 (2.5 full-size ICT modules 156x46mm)
Destination:	indoor
Weight:	3.6 / 3.97 [kg]
Notes:	knockouts: $\Phi 21,5$ / $\Phi 29,5$ mm (for cable glands) knockout: 26,7 x 30,5 mm (for IEC C14 socket with fuse)
Warranty:	2 years
Declaration:	CE

Operating parameters:

Protection grade EN60529:	IP 20
Operating conditions:	-10°C ... +40°C
Storage temperature:	-20°C ... +60°C
Relative humidity:	20% ... 90% , without condensation
Sinusoidal vibrations during operation:	unacceptable
Impulse waves during operation:	unacceptable
Direct insolation:	unacceptable
Vibrations and impulse waves during transport:	PN-83/T-42106

The mounting system provides high configuration flexibility. Each mounting space within the enclosure allows for the installation of:

- One full-size DIN rail module – e.g., a Protege 2-door controller, a 4A/8A power supply, or a full-size expander module; or
- Two half-size DIN rail modules – e.g., a Protege 1-door controller, a 2A power supply, or half-size expander modules; or
- One 7Ah battery (option available only in the bottom row of the enclosure; DIN rail removal required).

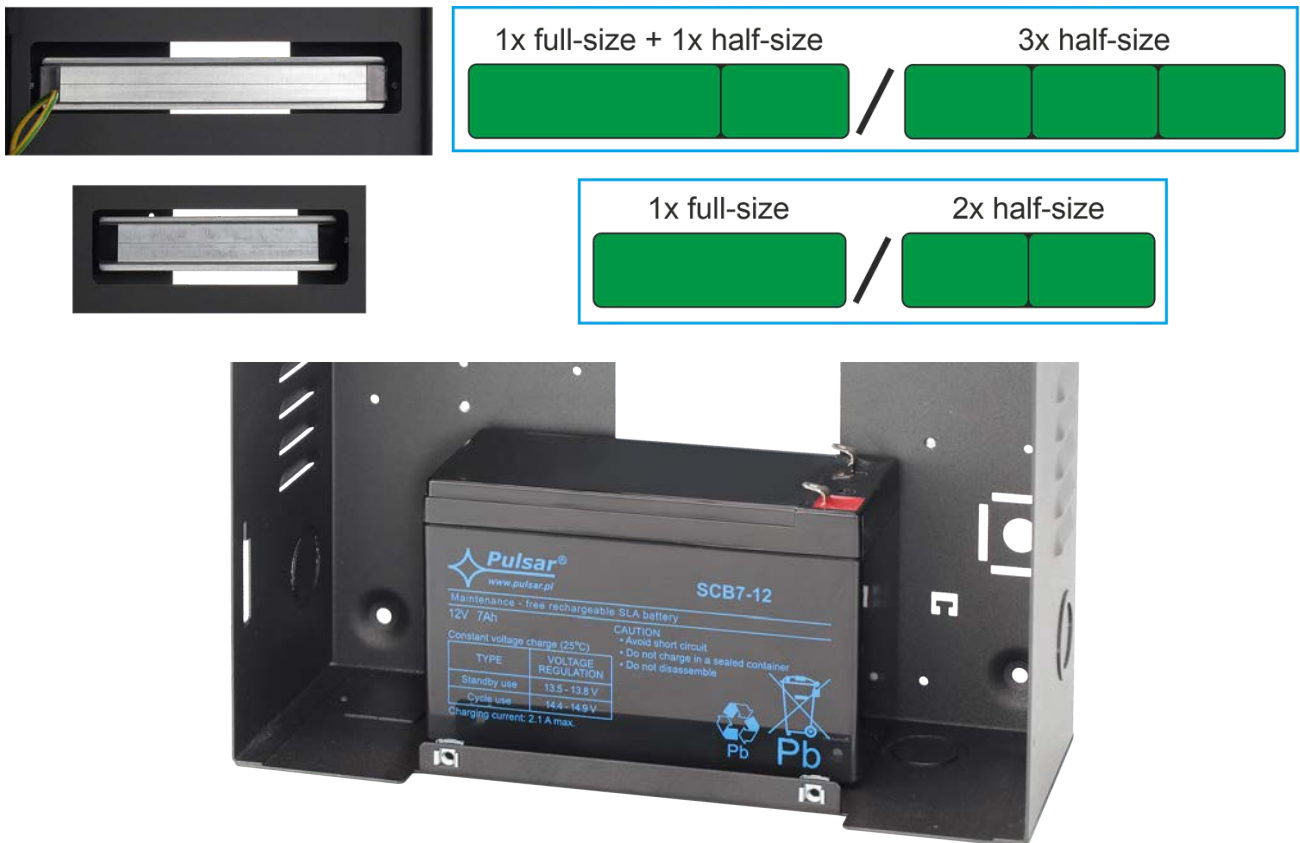

Enclosure equipped with tamper protection (tamper switches) against cover opening and detachment from mounting surface. Internal DIN rails mounted on 27mm spacers.

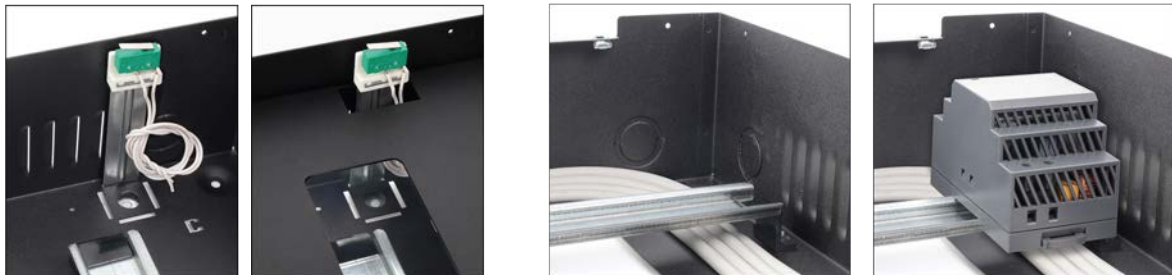

Structure features knockouts for installation of:

- cable glands ($\Phi=21.5$ mm / $\Phi=29.5$ mm openings)
- IEC C14 fused power inlet (26.7 x 30.5 mm opening)



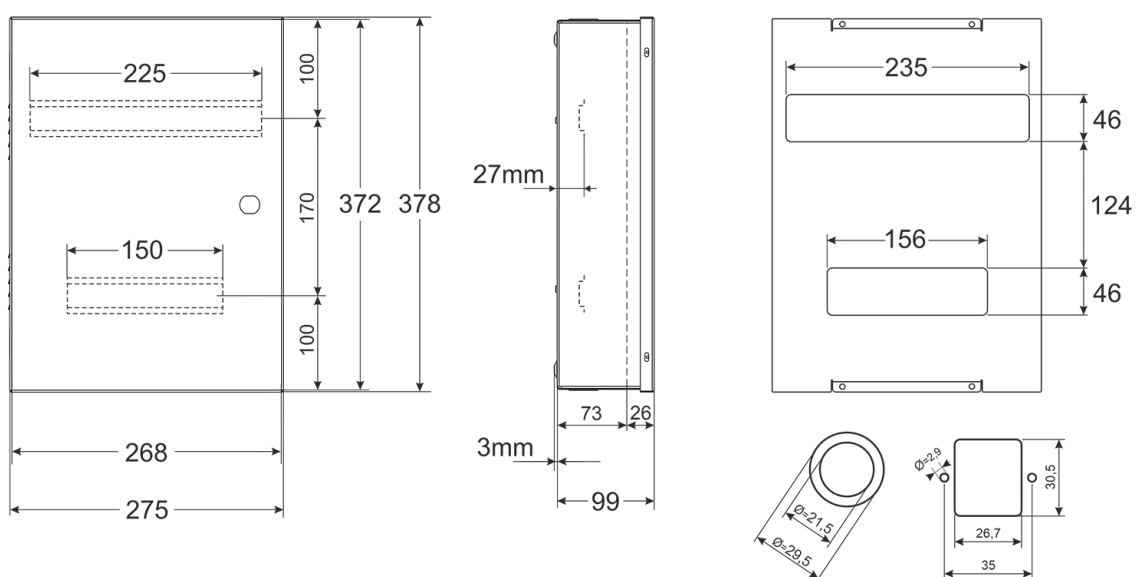

WEEE MARK
According to EU WEE Directive - It is required not to dispose of electric or electronic waste as unsorted municipal waste and to collect such WEEE separately



Device works with a lead-acid battery (SLA). After the operation period it must not be disposed of but recycled according to the applicable law.

Pulsar sp. j.
Siedlec 150, 32-744 Lapczyca,
Poland
tel.: +48-14-610-19-45
e-mail: sales@pulsar.pl
www.pulsar.pl

