



## DESTINATION

These enclosures are designed for the DIN rail mounting of ICT company access control system devices, including:

- Controller Modules:
  - PRT-CTRL-DIN-.... / PRT-WX-DIN-...
- Expander Modules:
  - PRT-RDM2-DIN-... / PRT-HRDM-DIN-... / PRT-ZX16-DIN-... / .....
- Power Supply Modules:
  - PRT-PSU-DIN-...

The design allows for the mounting of ICT modules in both full-size and half-size formats.

## TECHNICAL DATA

### Electrical parameters:

<b>Protections:</b>	Tamper protection - opening enclosure, removal from the wall 0.5A / 50 V DC, NC - normally closed
<b>Protection class EN 62368-1:</b>	I (first)
<b>Rated current of protective connection:</b>	6 A max.

### Mechanical parameters:

<b>Dimensions:</b>	434 x 541 x 99 [mm, +/-2] distance from surface: 3 mm
<b>External dimensions of front panel:</b>	440 x 547 [mm, +/-2]
<b>Dimensions of battery space :</b>	1 x 7Ah
<b>Material:</b>	steel DC01, RAL9005 (black), metallic, protection anticorrosion
<b>Closing:</b>	Key lock
<b>DIN rail:</b>	3 x 317mm 3 x 2 (6 full-size ICT modules 156x46mm)
<b>Destination:</b>	indoor
<b>Weight:</b>	7.5 / 8.12 [kg]
<b>Notes:</b>	knockouts: $\Phi 21,5$ / $\Phi 29,5$ mm (for cable glands) knockout: 26,7 x 30,5 mm (for IEC C14 socket with fuse)
<b>Accessories:</b>	DIN rail 150 mm + 2 brackets
<b>Warranty:</b>	2 years
<b>Declaration:</b>	CE

### Operating parameters:

<b>Protection grade EN60529:</b>	IP 20
<b>Operating conditions:</b>	-10°C ... +40°C
<b>Storage temperature:</b>	-20°C ... +60°C
<b>Relative humidity:</b>	20% ... 90% , without condensation
<b>Sinusoidal vibrations during operation:</b>	unacceptable
<b>Impulse waves during operation:</b>	unacceptable
<b>Direct insolation:</b>	unacceptable
<b>Vibrations and impulse waves during transport:</b>	PN-83/T-42106

The mounting system provides high configuration flexibility. Each mounting space within the enclosure allows for the installation of:

- One full-size DIN rail module – e.g., a Protege 2-door controller, a 4A/8A power supply, or a full-size expander module; or
- Two half-size DIN rail modules – e.g., a Protege 1-door controller, a 2A power supply, or half-size expander modules; or
- One 7Ah battery (option available only in the bottom row; requires replacing the factory 317mm rail with the included 150mm rail).



Enclosure equipped with tamper protection (tamper switches) against cover opening and detachment from mounting surface. Internal DIN rails mounted on 27mm spacers.

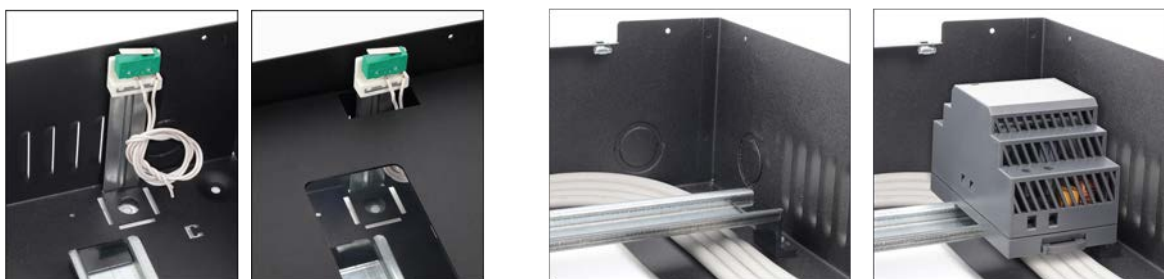

Structure features knockouts for installation of:

- cable glands ( $\Phi=21.5$  mm /  $\Phi=29.5$  mm openings)
- IEC C14 fused power inlet (26.7 x 30.5 mm opening)



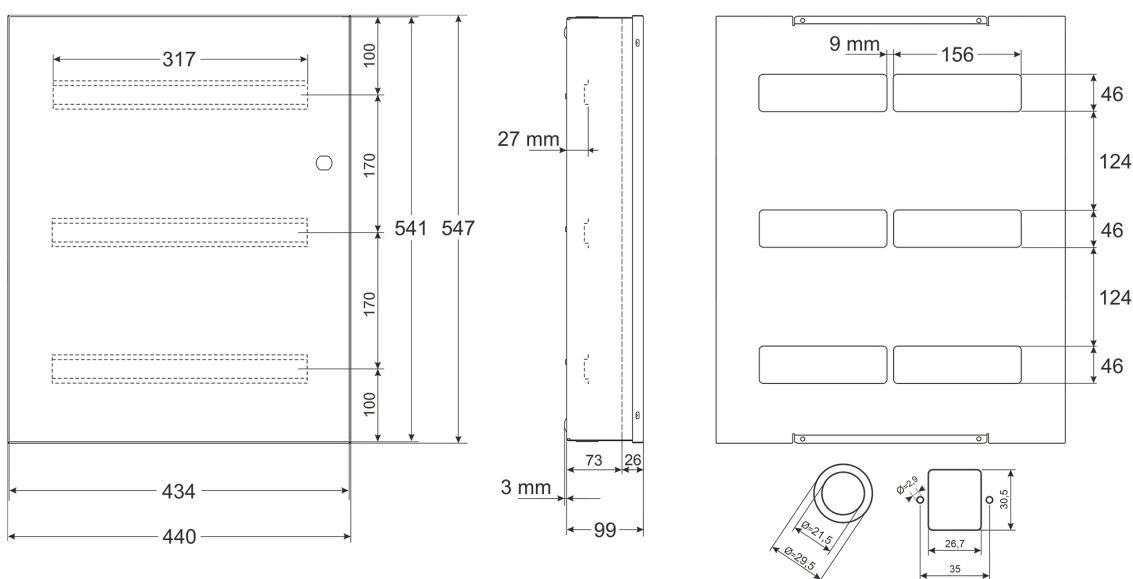

**WEEE MARK**  
According to EU WEE Directive - It is required not to dispose of electric or electronic waste as unsorted municipal waste and to collect such WEEE separately



*Device works with a lead-acid battery (SLA). After the operation period it must not be disposed of but recycled according to the applicable law.*

**Pulsar sp. j.**  
Siedlec 150, 32-744 Lapczyca,  
Poland  
tel.: +48-14-610-19-45  
e-mail: [sales@pulsar.pl](mailto:sales@pulsar.pl)  
[www.pulsar.pl](http://www.pulsar.pl)

