

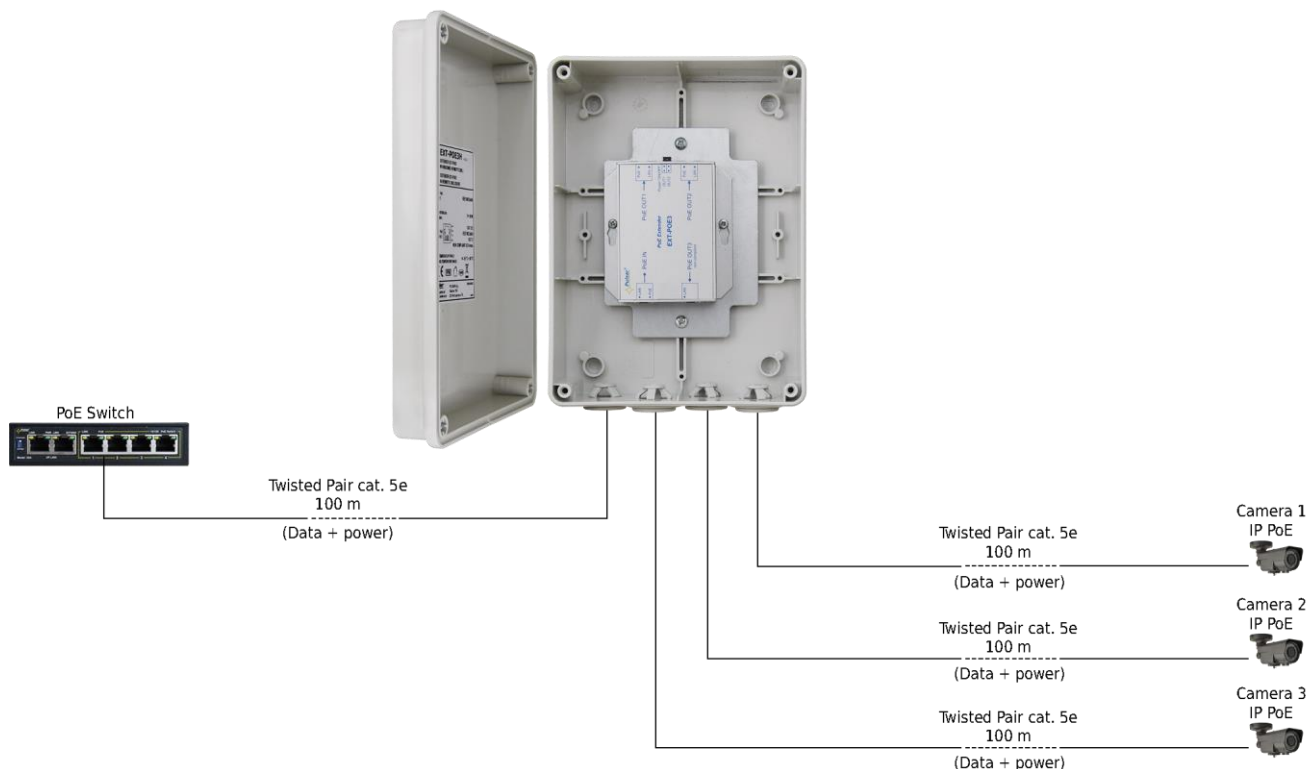

Features:

- The output voltage range 44-57 V DC
- Power from PoE switch
- The PoE IN input compliant with the IEEE802.3af/at standard
- The PoE OUT 1/2 output compliant with the IEEE 802.3af/at standard
- Output PoE OUT 3 – passive
- Increases Ethernet and PoE power range by 100 meters
- Designed for 10 Mb/s and 100 Mb/s network
- Pole mounting option
(requires the OZB2 adapter - optional accessory)
- The possibility to turn off power to the PoE OUT1 / 2 ports
- LED optical signalization
- protections:
 - surge protection (PoE input)
 - OLP overload protection
 - SCP short circuit protection
 - IP56 hermetic enclosure
- warranty – 1 year from the production date

Example of use.



Connection of three IP PoE cameras and extension of the range for another 100m

1. Technical description.

1.1. General description.

The **EXT-POE3H extender** is a device designed to increase the PoE and Ethernet range by additional 100 meters using UTP Cat. 5/5e cable. The Extender can be powered using a PoE switch or another PoE-compliant device (PoE IN input). The output voltage and data are available at the PoE OUT1 and OUT2 outputs designed for connecting cameras or other IP devices using PoE power supply. The maximum load current is 0,4A (see Tab.2). The PoE OUT1, PoE OUT2, PoE OUT3 port are supplied over 4/5 (+) and 7/8 (-) pairs, which, according to the Ethernet standard, are not used for data transmission (data transmission uses 1/2 and 3/6 twisted pairs).

1.2 Description components and connectors.

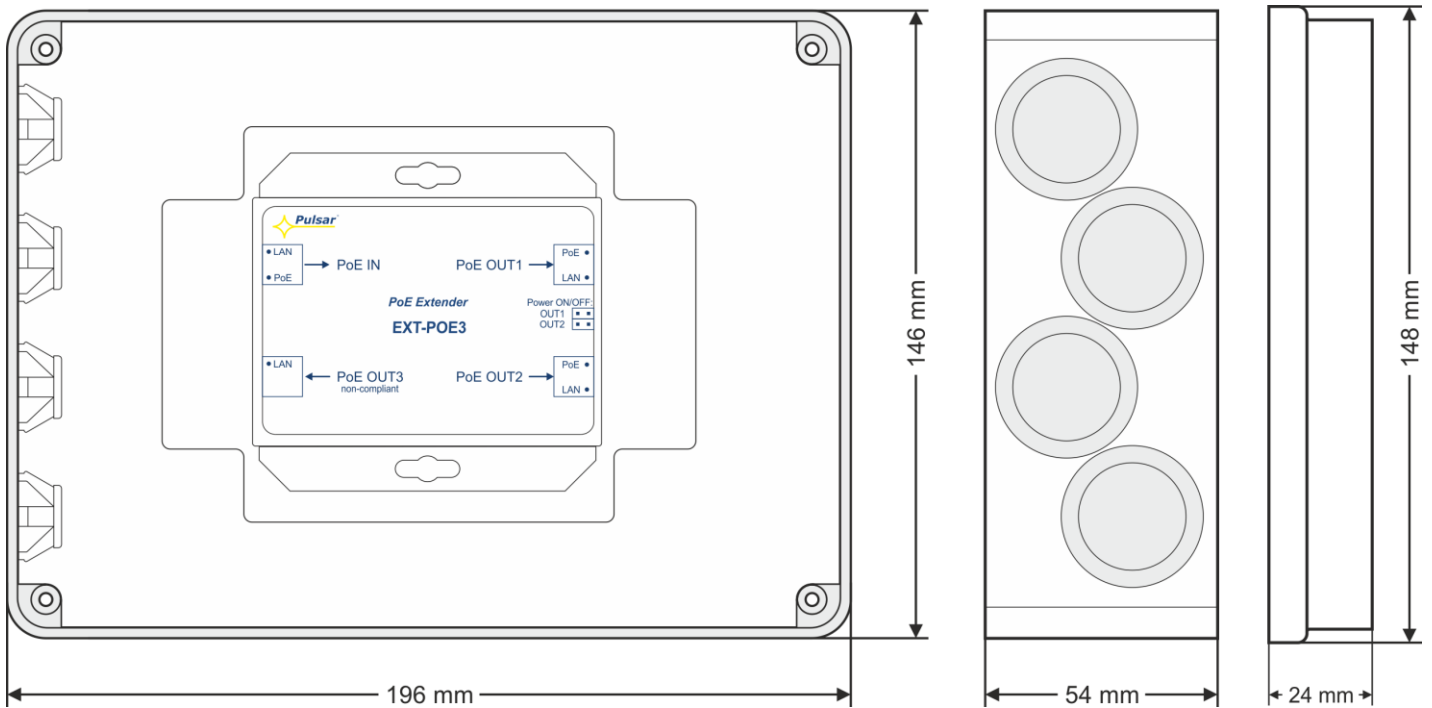



Fig. 1. View of enclosure.

Table 1. (See fig. 2)

| Element no. (Fig. 2) | Description |
|-------------------------|---|
| [1] | The PoE IN-input port |
| [2] | LED LAN (yellow) |
| [3] | LED PoE (green) |
| [4] | PoE OUT 1/2 - output ports |
| [5] | PoE OUT 3 – output port (passive) |
| [6] | Power ON/OFF – PoE OUT1 /2 power supply jumper OUTx  PoE supply OUTx  absence of PoE supply |

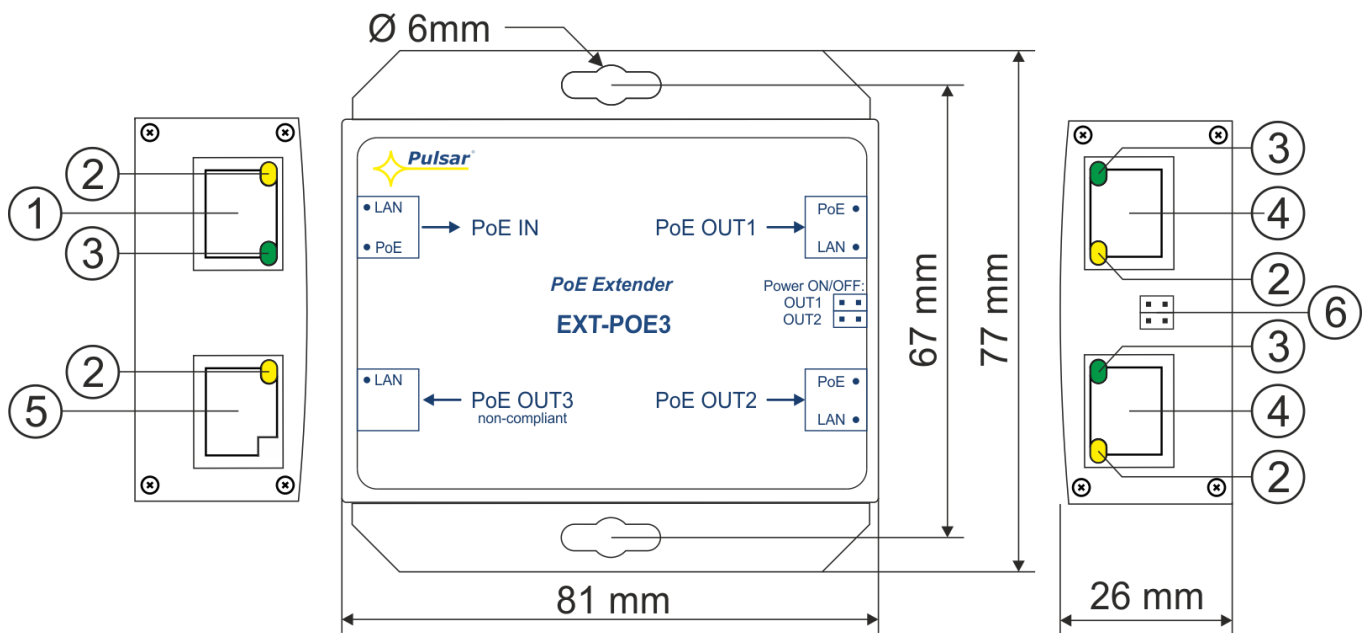

Fig. 2. The view of the extender.

1.3. Technical parameters.



Tabla 2.

| | |
|--|---|
| Supply voltage | compliant with 802.3af/at (44÷57 V DC) |
| Current consumption by PSU systems | <30mA |
| Module power | 20 W max. |
| Output voltage | Applying power |
| Output current | 0,4A PoE ports OUT1/2, 0,3A PoE port OUT3 ($\Sigma=0,4A$ max.) |
| The PoE IN input power supply pairs | 1/2 (+) 3/6(-) 4/5 (+) 7/8 (-) |
| The PoE OUT1/2 output power supply pairs | 4/5 (+) 7/8 (-) |
| Overload protection OLP | PoE OUT1/2: 105% ÷ 150% of nominal output current, automatic recovery |
| Short circuit protection SCP | PoE OUT3: PTC 0,5A, polymer fuse |
| LED operation indication | Yellow LAN LED - indicating the LAN connection status Green PoE LED - presence of input/output voltage |
| Range of operating temperatures | -25°C÷50°C |
| External dimensions | W=158, H=118, D=77 [+/- 2 mm] |
| Height glands | H ₁ =25 [mm] |
| The number of cable glands/ Ø cables | 4 pcs. / 4÷8mm |
| Connectors: - IN/OUT PoE | RJ45 8P8C |
| Net/gross weight | 0,42 / 0,48 [kg] |
| Storage temperature | -25°C...+60°C |

2. Installation.

2.1. Requirements.

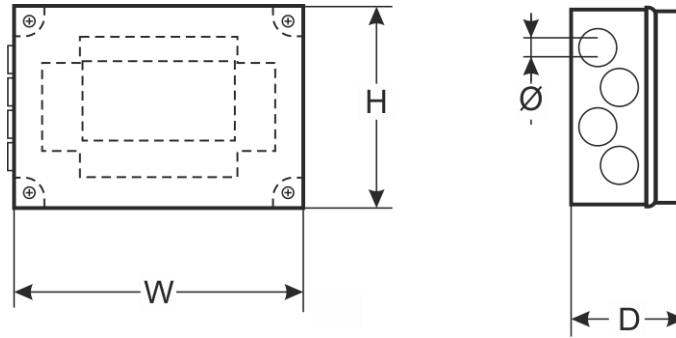
The extender should be mounted by a qualified installer, holding relevant permits and licenses (applicable and required for a given country) for low-voltage installations. The device should be mounted in a place protected from weather conditions and direct sun, with temperatures from -25°C to + 50°C. Thanks to the use of the OZB2 mounting plate (optional accessory), it is possible to mount the device on a pole (not included).

The device is designed for a 10 Mb/s or 100 Mb/s Ethernet network (the so-called Fast Ethernet). However, it cannot be used in 1 Gb/s networks (the so-called Gigabit Ethernet). The minimum category cable recommended to connect the extender and the network device is UTP Cat. 5 cable. In the case of an external installation, it must be resistant to UV radiation.

2.2. Installation procedure.

Mount the device in the chosen location and route the connection wires. Pull cables through cable glands, then tighten plugs. Connect the network cables (Ethernet) to the RJ45 connectors marked PoE IN and PoE OUT. Connect the RJ45 cable from the Ethernet switch to the PoE IN jack compatible with the PoE standard, taking into account the current efficiency of the output port. Connect the devices compatible with the IEEE802.3af/at standard, e.g. IP cameras, to the PoE OUT 1/2 ports. All devices using the PoE power with a voltage in the range of 44 ÷ 57 V DC can be connected to the PoE OUT3 port.

3. Maintenance.

Any and all maintenance operations may be performed following the disconnection of the power supply from the power network. The power supply does not require any specific maintenance procedures, however, in the case of significant level of dust, it should be cleaned with compressed air.



WEEE MARK

According to the EU WEE Directive – It is required not to dispose of electric or electronic waste as unsorted municipal waste and to collect such WEEE separately



Pulsar sp. j.

Siedlec 150, 32-744 Łapczyca, Poland
Tel. (+48) 14-610-19-40, Fax. (+48) 14-610-19-50
e-mail: biuro@pulsar.pl, sales@pulsar.pl
http:// www.pulsar.pl, www.zasilacze.pl