

CODE: **AWO452** v1.5/II
 NAME: **EXPANDER 1**

EN

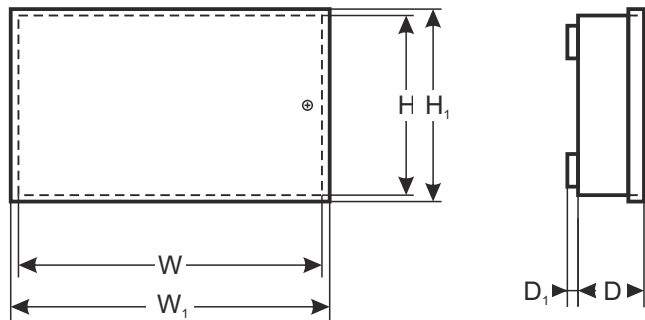

DESTINATION

DSC:

- 1) 2x (4108, 5108, 6108, 5208, 5100, 4116)
- 2) 1x (4216, 4580, 5400, 5580)

SATEL:

- 1) 2x (CA10E, CA64E, SM, MST1)
- 2) 1x CA64 (PP, EPS, O-OC, O-ROC, O-R, OPS-OC, OPS- ROC, OPS-R, VGM-16, SR, ADR, ACC-KP- PS, PTSA)

PARADOX:

- 1) 2x (ZX4, ZX8, HUB2, ADM2, PGM4)

RISCO:

- 1) 1x (EZ8, EZ16, E04, E08)

DANE TECHNICZNE

| | |
|--|---|
| External dimensions of the enclosure: | W=218, H=150, D+D ₁ =50+8 [± 2mm] |
| External dimensions of the front panel: | W ₁ =222, H ₁ =155 [± 2mm] |
| Weight net/gross: | 0,70 / 0,75 [kg] |
| Operating environment: | class II, -10°C÷ 40°C |
| Material description: | sheet steel DC01, thickness: 0,7mm, protection anticorrosion, color: RAL 9003 |
| Destination: | indoor |
| Tamper protection: | 1 x microswitch: opening, 0,5 A@50 V DC max. NC - normally closed contacts |
| Zamykanie: | sheet-metal screws x 1 |
| Uwagi: | distance from wall (mounting surface) - 8mm |
| Deklaracje, gwarancja: | CE, 2 lata od daty produkcji |